

**MOUNTING FLANGE (SAE J744)**

**-SB2**

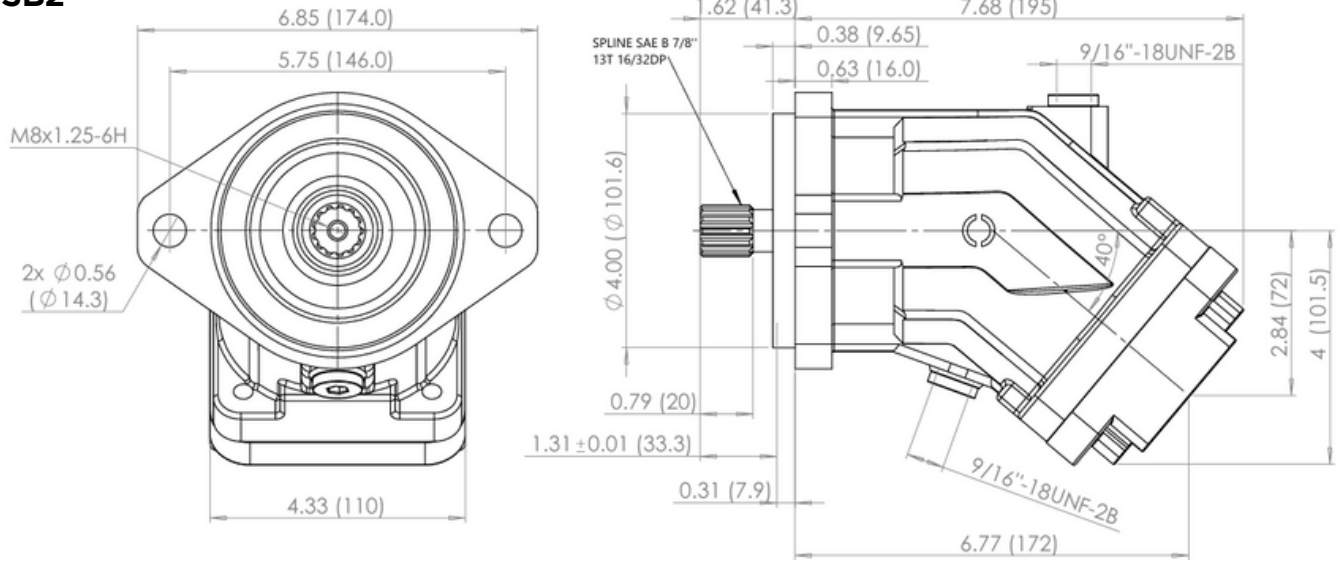

**-SB4**

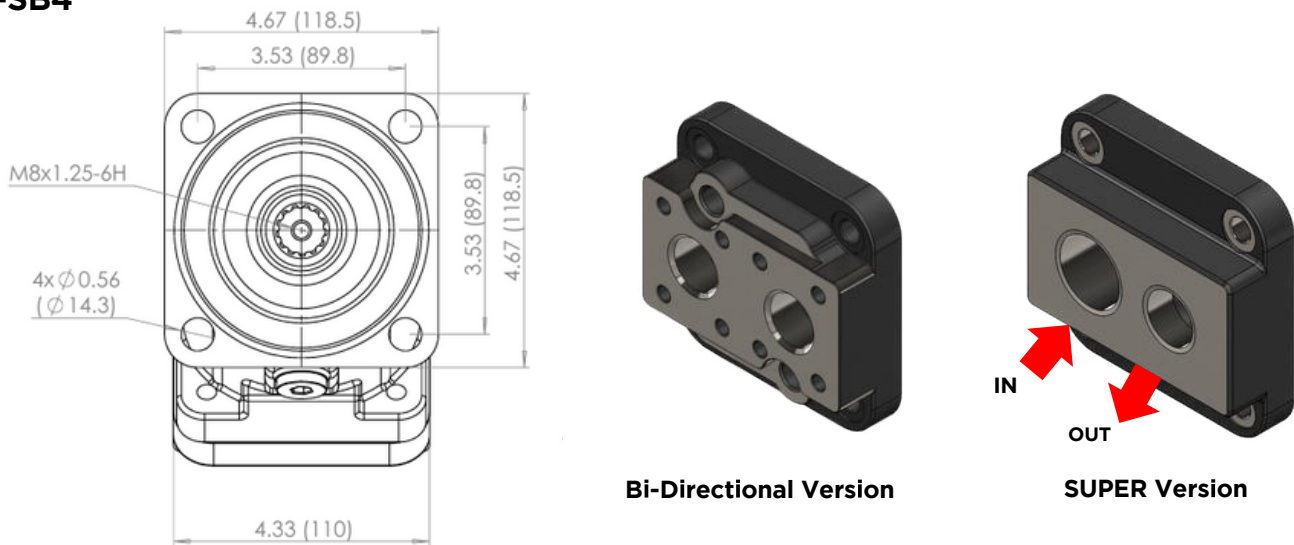

**Bi-Directional Version**

**SUPER Version**

**-Shaft**

**Spline Shaft**

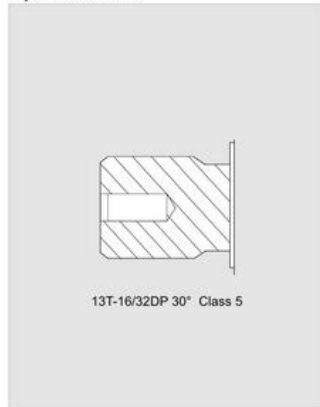

**Keyed Shaft**

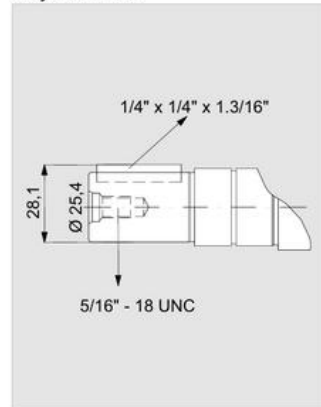

**Keyed Shaft**

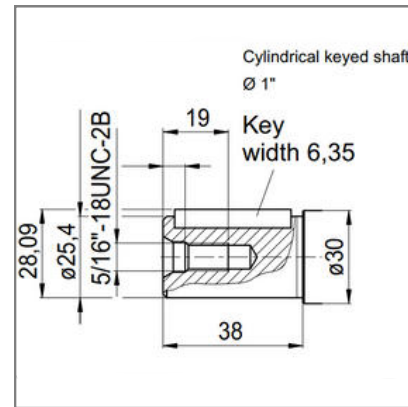

<b>x 1000 rpm</b>	12,00 cc
<b>x 1500 rpm</b>	18,00 cc
<b>Max. Continuous Pump Speed</b>	2300 rpm
<b>Max. Limited Pump Speed</b>	3100 rpm
<b>Max. Continuous Pressure</b>	350 bar
<b>Max. Intermit. Peak Pressure</b>	400 bar
<b>Max. Torque at 350 bar</b>	71 Nm
<b>Weight without inlet fitting</b>	9,00 kg
<b>Weight with inlet fitting</b>	9,40 kg
<b>Torque without inlet fitting</b>	8,70 N.m
<b>Torque with inlet fitting</b>	9,15 N.m
<b>Rotation</b>	CW-CCW
<b>Fluid</b>	Min. B. Hyd. Oil
<b>Inlet &amp; Outlet</b>	3/4"

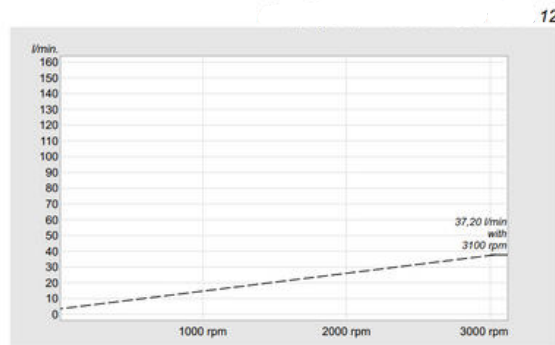

<b>x 1000 rpm</b>	18,00 cc
<b>x 1500 rpm</b>	27,00 cc
<b>Max. Continuous Pump Speed</b>	2300 rpm
<b>Max. Limited Pump Speed</b>	2900 rpm
<b>Max. Continuous Pressure</b>	350 bar
<b>Max. Intermit. Peak Pressure</b>	400 bar
<b>Max. Torque at 350 bar</b>	105 Nm
<b>Weight without inlet fitting</b>	9,00 kg
<b>Weight with inlet fitting</b>	9,40 kg
<b>Torque without inlet fitting</b>	8,75 N.m
<b>Torque with inlet fitting</b>	9,19 N.m
<b>Rotation</b>	CW-CCW
<b>Fluid</b>	Min. B. Hyd. Oil
<b>Inlet &amp; Outlet</b>	3/4"

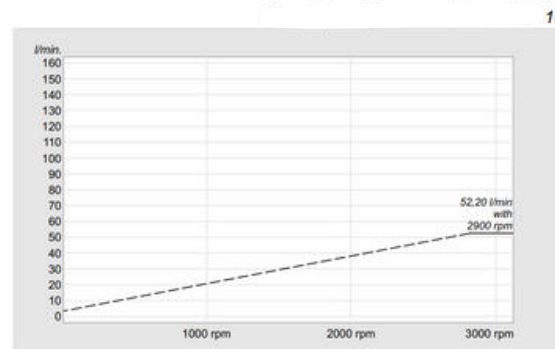

<b>x 1000 rpm</b>	25,00 cc
<b>x 1500 rpm</b>	37,50 cc
<b>Max. Continuous Pump Speed</b>	2300 rpm
<b>Max. Limited Pump Speed</b>	2700 rpm
<b>Max. Continuous Pressure</b>	350 bar
<b>Max. Intermit. Peak Pressure</b>	400 bar
<b>Max. Torque at 350 bar</b>	146 Nm
<b>Weight without inlet fitting</b>	9,50 kg
<b>Weight with inlet fitting</b>	9,90 kg
<b>Torque without inlet fitting</b>	8,82 N.m
<b>Torque with inlet fitting</b>	9,23 N.m
<b>Rotation</b>	CW-CCW
<b>Fluid</b>	Min. B. Hyd. Oil
<b>Inlet &amp; Outlet</b>	3/4"

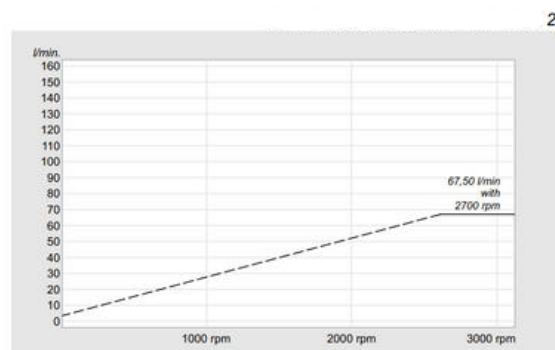

Charts are for Bi-directional. Super version has better high speed performance and suction character.



## C-2PE: Ordering Code and Specifications Table

Type Code	Displacement (cm3)	Rotation	Version	Sealing	Mounting Flange	Shaft	Flow	Inlet Fitting
C-2PE	12,18,25,32, 40,50,63,80, 108,130	Right, Left (cw,ccw)	Special Classic (S,C)	Nitrile, Viton (N,V)	According the Specifications	According the Specifications	S, B (Super, Bidirectional)	A (Inculet with Bidirectional and cover)

	12	18	25	32	40	50	63	80	108	130	
SB2	●	●	●	●	●						SAE B-2 Hole
SB4	●	●	●	●	●	●	●				SAE B-4 Hole
SC4						●	●	●	●	●	SAE C-4 Hole

	12	18	25	32	40	50	63	80	108	130	
B13	●	●	●	●	●	●	●				SAE B 13T 16/32
BB15				●	●	●	●				SAE BB 15T 16/32
C14						●	●	●	●	●	SAE C 14T 12/24
D13								●	●	●	SAE D 13T 8/16
K1	●	●	●	●	●	●	●				1" Parallel Keyed
K1114				●	●	●	●	●	●	●	1 1/4" Parallel Keyed

### ISO1179, SAE J1926, ISO6149

\*Availabe on Request

Bidirectional Rear			
IN	OUT		
12	G3/4, SAE 12	G3/4, SAE 12	
18	G3/4, SAE 12	G3/4, SAE 12	
25	G3/4, SAE 12	G3/4, SAE 12	
32	G1, SAE 16	G1, SAE 16	
40	G1, SAE 16	G1, SAE 16	
50	G1, SAE 16	G1, SAE 16	<b>B02</b>
63	G1, SAE 16	G1, SAE 16	
80	G1, SAE 16	G1, SAE 16	<b>IN</b> <b>OUT</b>
108	G1, SAE 16	G1, SAE 16	G1 1/4, SAE 20    G1 1/4, SAE 20
130	G1, SAE 16	G1, SAE 16	G1 1/4, SAE 20    G1 1/4, SAE 20

Super Rear			
IN	OUT		
12	G3/4, SAE 12	G3/4, SAE 12	
18	G1, SAE 16	G1/2, SAE 8	
25	G1, SAE 16	G3/4, SAE 12	
32	G1 1/4 SAE 20	G3/4, SAE 12	
40	G1 1/4 SAE 20	G3/4, SAE 12	
50	G1 1/4 SAE 20	G3/4, SAE 12	<b>S02</b>
63	G1 1/4 SAE 20	G3/4, SAE 12	
80	G1 1/2 SAE 24	G1, SAE 16	<b>IN</b> <b>OUT</b>
108	G1 1/2 SAE 24	G1, SAE 16	G1 1/4, SAE 20    G1 1/4, SAE 16
130	G1 1/2 SAE 24	G1, SAE 16	G1 1/4, SAE 20    G1 1/4, SAE 16