

**MOUNTING FLANGE (SAE J744)**

**-SB2**

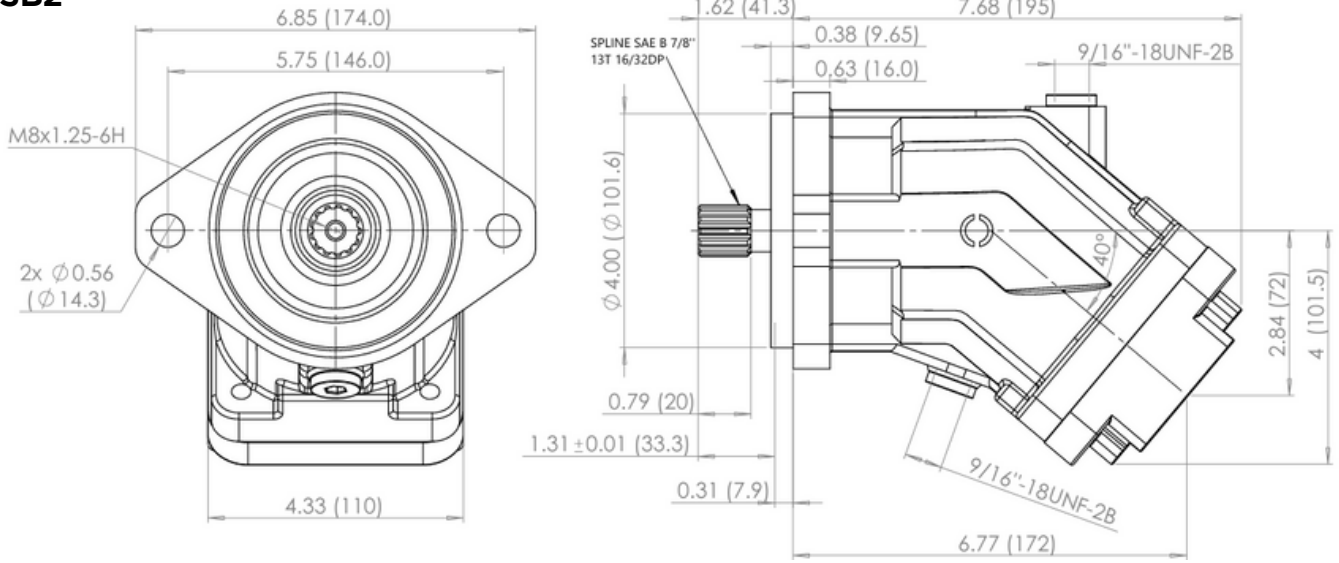

**-SB4**

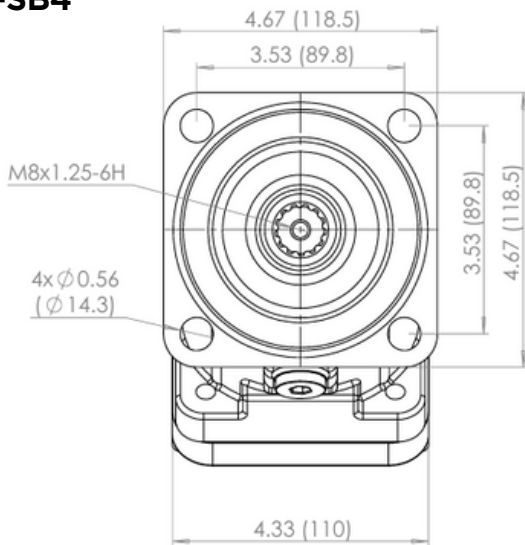

**-PORTING OPTIONS**

With BSP, SAE O-ring boss, ISO 6149 Threading



**-Shaft**

**Spline Shaft**

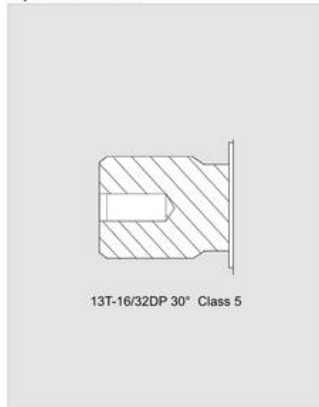

**Keyed Shaft**

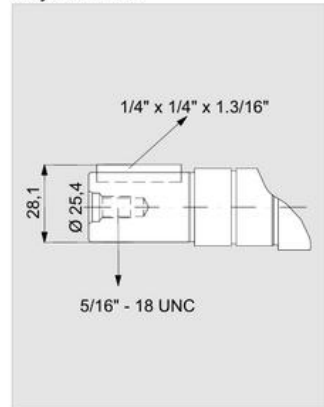

**Keyed Shaft**

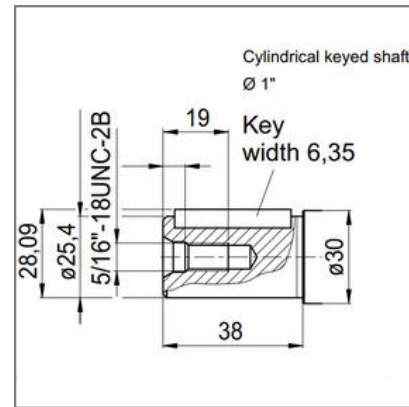

Compare Table of Torque

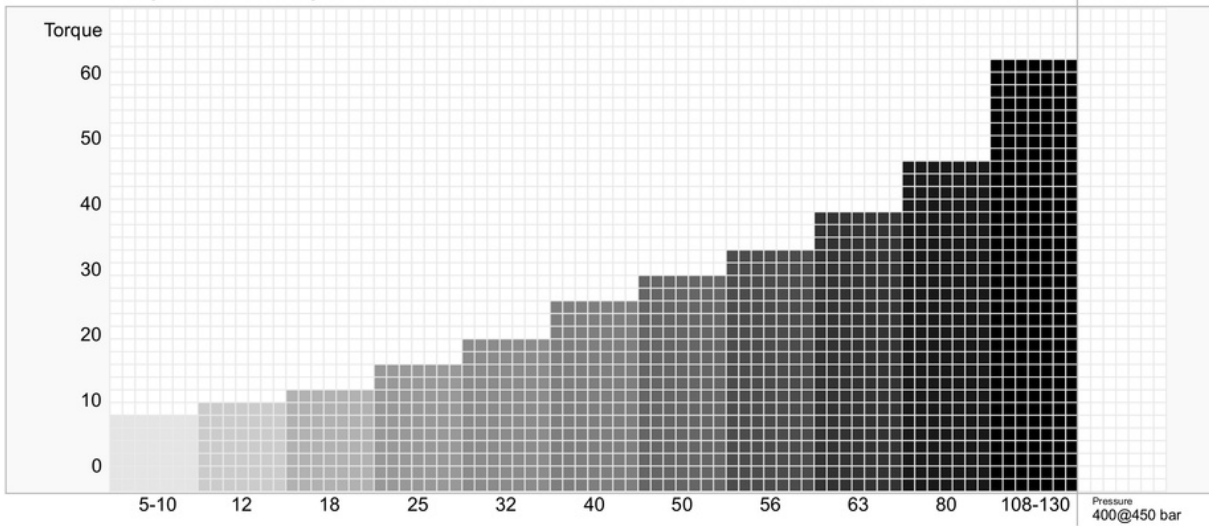

Efficiency of 2PEM Motors

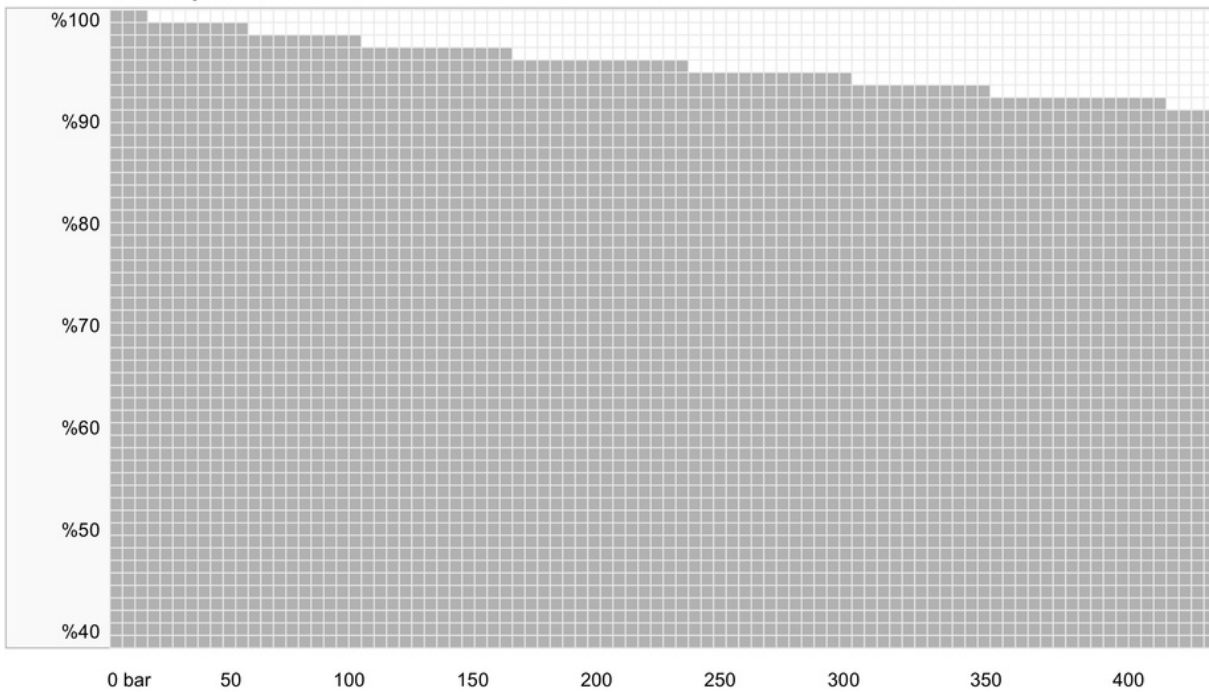

## C-2PEM: Ordering Code and Specifications Table

Type Code	Displacement (cm3)	Rotation	Version	Sealing	Mounting Flange	Shaft	Flow
C-2PEM	12,18,25,32, 40,50,63,80, 108,130	Both (cw,ccw)	Special Classic (S,C)	Nitrile, Viton (N,V)	According the Specifications	According the Specifications	R, S, RS (Super, Bidirectional)

	12	18	25	32	40	50	63	80	108	130	
<b>SB2</b>	●	●	●	●	●						SAE B-2 Hole
<b>SB4</b>	●	●	●	●	●	●	●				SAE B-4 Hole
<b>SC4</b>						●	●	●	●	●	SAE C-4 Hole

	12	18	25	32	40	50	63	80	108	130	
<b>B13</b>	●	●	●	●	●	●	●				SAE B 13T 16/32
<b>BB15</b>				●	●	●	●				SAE BB 15T 16/32
<b>C14</b>						●	●	●	●	●	SAE C 14T 12/24
<b>D13</b>								●	●	●	SAE D 13T 8/16
<b>K1</b>	●	●	●	●	●	●	●				1" Parallel Keyed
<b>K1114</b>				●	●	●	●	●	●	●	1 1/4" Parallel Keyed

### ISO1179, SAE J1926

\*Availebe on Request

Rear Ports		R02	
<b>12</b>	G3/4, SAE 12		
<b>18</b>	G3/4, SAE 12		
<b>25</b>	G3/4, SAE 12		
<b>32</b>	G1, SAE 16		
<b>40</b>	G1, SAE 16		
<b>50</b>	G1, SAE 16		
<b>63</b>	G1, SAE 16		
<b>80</b>	G1, SAE 16	<b>80</b>	G1, SAE 16
<b>108</b>	G1, SAE 16	<b>108</b>	G1, SAE 16
<b>130</b>	G1, SAE 16	<b>130</b>	G1, SAE 16

Side Ports	
<b>12</b>	G3/4, SAE 12
<b>18</b>	G3/4, SAE 12
<b>25</b>	G3/4, SAE 12
<b>32</b>	G1, SAE 16
<b>40</b>	G1, SAE 16
<b>50</b>	G1, SAE 16
<b>63</b>	G1, SAE 16
<b>80</b>	G1, SAE 16
<b>108</b>	G1, SAE 16
<b>130</b>	G1, SAE 16

Rear + Side Ports		
	Rear	Side
<b>12</b>	G3/4, SAE 12	G3/4, SAE 12
<b>18</b>	G3/4, SAE 12	G1/2, SAE 8
<b>25</b>	G3/4, SAE 12	G3/4, SAE 12
<b>32</b>	G1, SAE 16	G1, SAE 16
<b>40</b>	G1, SAE 16	G1, SAE 16
<b>50</b>	G1, SAE 16	G1, SAE 16
<b>63</b>	G1, SAE 16	G1, SAE 16
<b>80</b>	G1, SAE 16	G1, SAE 16
<b>108</b>	G1, SAE 16	G1, SAE 16
<b>130</b>	G1, SAE 16	G1, SAE 16

